

Technical data sheet

Beam clamp, with fastening hole

Item number: 1488265



Support clamp with drill hole for individual mounting solutions, e.g. to accept S hooks or chains. Fastening through knocking onto steel girders.



CE

- St** Steel
- ZL** Zinc slat

Master data

Item number	1488265
Type	SCVH 10-15
Description 1	Beam clamp
Description 2	with fastening hole
Manufacturer	OBO
Dimension	10-15mm
Material	Steel
Surface	Zinc slat
Surface standard	
Smallest sales unit	100
Unit of quantity	Piece
Weight	1.8 kg
Weight unit	kg/100 pc.

Technical data sheet

Beam clamp, with fastening hole

Item number: 1488265



Dimensions

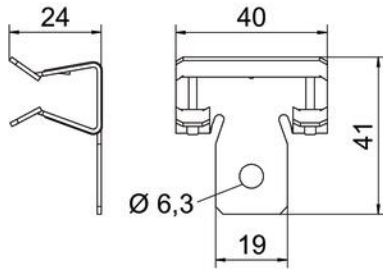

Length	41 mm
Width	40 mm
Height	24 mm
Dimension L	41 mm
Maß W	40 mm

Technical data

Connection type/component	Hole
Fastening type	Clamp
Fastening hole	6.5 mm
Flange thickness F max.	15 mm
Flange thickness F min.	10 mm
Hinge, adjustable	no
Hinged	no