

Technical data sheet

Support clamp for cables

Item number: 1488519



Support clamp for mounting cables. Open cable seat at side. Fastening through knocking onto steel girders.

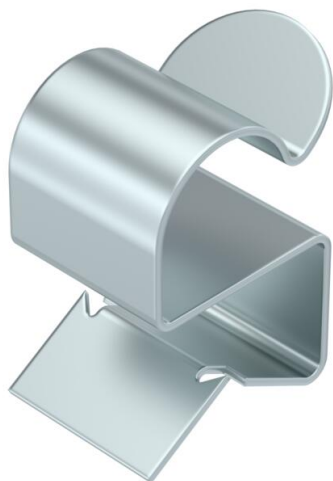

CE

St Steel

ZL Zinc slat

Master data

Item number	1488519
Type	SCC 7,5-12 D14
Description 1	Beam clamp
Description 2	for cable, 12-14mm
Manufacturer	OBO
Dimension	7,5-12mm
Material	Steel
Surface	Zinc slat
Surface standard	
Smallest sales unit	100
Unit of quantity	Piece
Weight	0.8 kg
Weight unit	kg/100 pc.

Technical data sheet

Support clamp for cables

Item number: 1488519



Dimensions

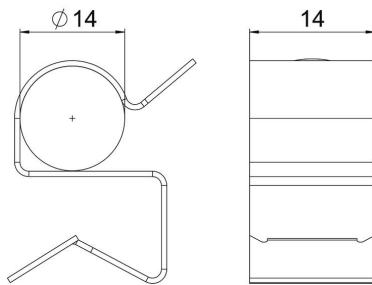

Length	21 mm
Width	14 mm
Height	25 mm
Maß W	14 mm

Technical data

Connection type/component	Pipe/cable
Fastening type	Clamp
Flange thickness F max.	12 mm
Flange thickness F min.	7.5 mm
Pipe/cable diameter, max.	14 mm
Pipe/cable diameter, min.	12 mm
Hinge, adjustable	no
Hinged	no