

# Technical data sheet

## Head plate, longitudinal SOMY

Item number: 7193017



Head plate for mounting on IS 8 support. The cable trays and ladders run in a longitudinal direction.  
The head plate is mounted to fixed lengths of the U support, type IS 8, using truss-head bolts, type FRS M10 x 25. The length of the support is limited to max. 2,000 mm. The surface coating is a coating created in a single-dip method with extra-high zinc thicknesses.



**St** Steel

**FT SO** Hot-dip galvanised 85 µm

### Master data

|                     |                          |
|---------------------|--------------------------|
| Item number         | 7193017                  |
| Type                | KI 8 FT SO               |
| Description 1       | Head plate               |
| Description 2       | for IS 8 support         |
| Manufacturer        | OBO                      |
| Dimension           | 200mm                    |
| Material            | Steel                    |
| Surface             | Hot-dip galvanised 85 µm |
| Surface standard    | DIN EN ISO 1461          |
| Smallest sales unit | 1                        |
| Unit of quantity    | Piece                    |
| Weight              | 156 kg                   |
| Weight unit         | kg/100 pc.               |

# Technical data sheet

## Head plate, longitudinal SOMY

Item number: 7193017



### Dimensions

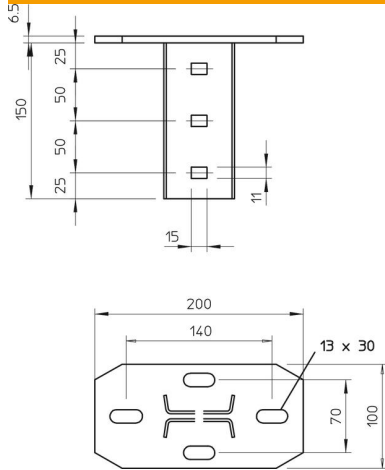

|        |        |
|--------|--------|
| Length | 200 mm |
| Width  | 100 mm |
| Height | 150 mm |

### Technical data

|                                |                  |
|--------------------------------|------------------|
| Version for                    | Screw head plate |
| Suitable for ceiling fastening | yes              |
| Suitable for panel fastening   | no               |
| Suitable for profile shapes    | I profile        |
| Rustproof steel, pickled       | no               |
| Angle range, max.              | 90 mm            |
| Angle range, min.              | 90 mm            |